

CERTIFIED RECORD OF LAND CORNER MONUMENTATION

**History of original corner establishment:**

Corner was first established by William R. Gradon in 1885 under Contract No. 519, dated October 2, 1884.

Set a post 3½' long, 3" square, 24" in the ground, at Corner.

14" Diam. Tamarack, N.48°W., 28 lks., mkd., 1/4SBT.

14" Diam. Tamarack, S.44°E., 9 lks., mkd., 1/4SBT.

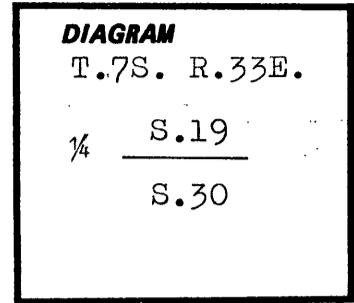

**Description of corner evidence found:**

Corner post gone.

Original 14" diam. Tamarack, N.48°W., 28 lks., dead and down, with scribes 4S visible.

Original 14" diam. Tamarack, S.44°E., 9 lks., felled, with scribes 1/4SBT visible.

**Description of monument and accessories | established to perpetuate the original location of this corner:**

Set a 2½" diam. Brass cap in a 2" X 30" iron pipe at average bearing and distance from B.T.'s.. Cap mkd. per sketch. Set steel posts with mon. and attn. signs attached, 4'±, E. & W. of Corner.

T7S R33E  
¼ S19  
S30  
RPLS 1910  
1985

8" D.B.H. Douglas Fir, N.37½°E., 40.2', scribed 1/4S19BT.

16" D.B.H. Douglas Fir, S.1°W., 36.4' scribed 1/4S30BT.

Each B.T. has a brass washer stamped RPLS 1910 set btwn.

the B & T , a B.T. tag, attn. sign and bands and faces painted red.

Declination; 18° 45' East.

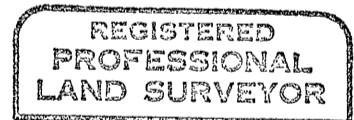

*Clayton J. Martin*



C.J. MARTIN SURVEYING  
2751 JUNIPER ST.  
SWEET HOME, OR 97386

Office of Surveyor County of Grant  
State of Oregon, I hereby certify that the within instrument was filed in this office  
for record on the 13 day of Aug, 1985  
Robert D. Boyette by \_\_\_\_\_  
(COUNTY OFFICIAL) (DEPUTY)